

Original Twist Cam System

SWC-S

SCREW CAM CLAMP (Double Eye Type)
Twist Cam Type PAT.

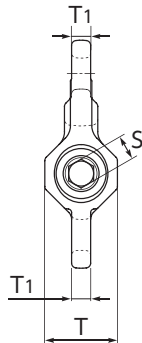
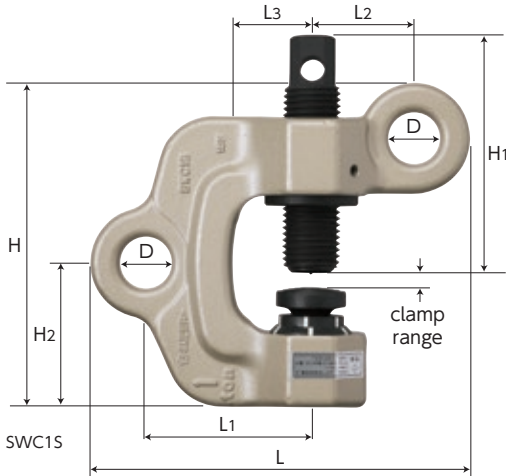

Example of use ⚠ Always lift a load at 2 or more points for safety.
In case of lifting down, cannot be set to slanted-shape part such as steel I beams.

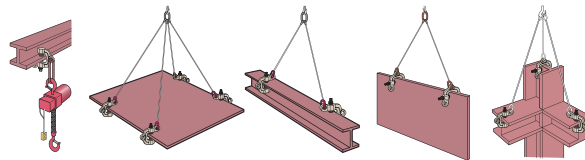

*Common to all the screw cam clamps (SCC, SCC-W, SDC-S, SJC-S, SDC-N, SDC-WN, SJC, SUC, SWC-N, SSC-N, SWC-S).

● The clamp cannot be used for the load shapes described below.

DO NOT USE

- * Even with wedge shape under 8°, the clamp cannot be used if the clamp part has a taper in the lifting direction.
- Round bars
- Curved shape with radius under 11.81in
- Objects with uneven clamp part
- Cylinders with inner diameter under 23.62in

Accessories ● 17x21 Double Size Ratchet Wrench (Short Type)

Features

- All-purpose clamp that can be used for a variety of operations such as lifting up and down, lateral pulling and turning over.
- Adequacy of tightening can be visually confirmed by secure and safe structure of the twist cam.
- When used in horizontal lifting, the screw is placed on top (operator's side), so the tightening operation can be done easily (when installing underneath a beam, the tightening can be done on the operator's side).
- The tightening mechanism with a screw and a circular cam (special spring type) provides sure clamping force on a load even when the load is landed or when vibrations occur during the lifting operation.
- The tightening check marks have phosphorescent (glow in the dark) paint for easy visual recognition.

Tightening operation

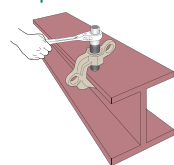

Visual safety check

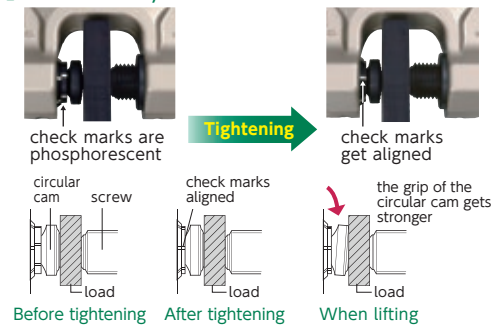

Item No.	Rated capacity (ton)	Clamp range (in)	Size (in)											N.W. (lb)
			L	L1	L2	L3	H	H1	H2	D	T	T1	S	
SWC0.5S	0.5	0.00~0.98	5.96	2.48	1.71	1.18	5.12	3.46	2.26	0.87	1.97	0.55	0.67	4.19
SWC1S	1	0.00~1.57	7.54	3.31	2.03	1.57	6.46	4.72	2.85	1.02	2.40	0.63	0.83	7.72
SWC2S	2	0.00~1.57	8.82	3.70	2.44	1.57	7.24	5.08	3.11	1.26	3.03	0.71	0.83	12.79

Note : After having checked that the check marks are aligned, operate tightening over 18.44ft·lb.

Normal Type

SWC-N

SCREW CAM CLAMP (Double Eye Type) PAT.

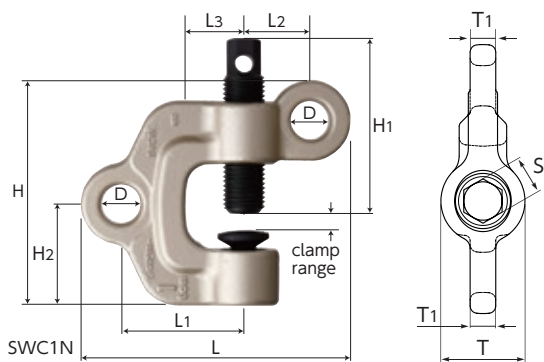

Example of use - Features

* The features (except the twist cam with check marks) and the examples of use are the same as SWC-S.

Accessories

● 17x21 Double Size Ratchet Wrench (Short Type)

Item No.	Rated capacity (ton)	Clamp range (in)	Size (in)											N.W. (lb)
			L	L1	L2	L3	H	H1	H2	D	T	T1	S	
SWC0.5N	0.5	0.00~0.98	5.79	2.48	1.54	1.18	4.80	3.50	1.77	0.87	1.81	0.55	0.83	3.97
SWC1N	1	0.00~1.57	7.28	3.31	1.77	1.57	6.14	4.76	2.30	1.02	1.97	0.63	0.83	7.05
SWC2N	2	0.00~1.57	8.46	3.70	2.09	1.57	6.69	4.76	2.50	1.26	2.36	0.71	0.83	11.02

Note : For the torque value of the screw tightening, operate tightening over 18.44ft·lb.