

» Swivel Type

SLH-S

SUPER LOCK HOOK

CHECK!



Operation manual, parts drawing and movie

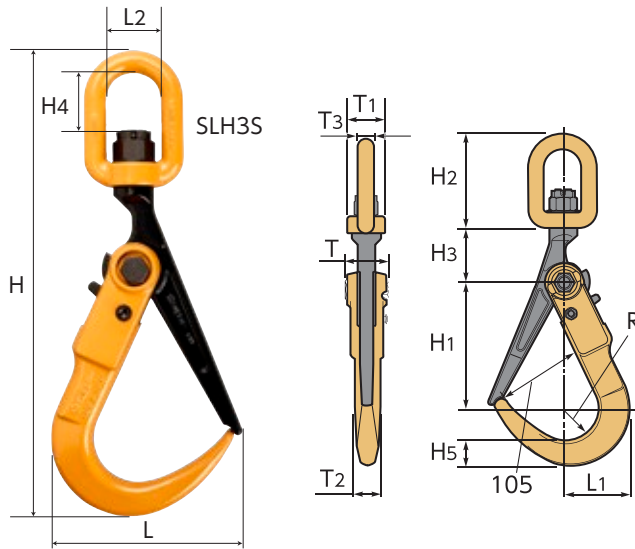

Example of use

▮ Laying and removing road plates

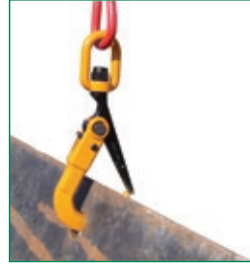

▮ As a safety hook for direct lifting

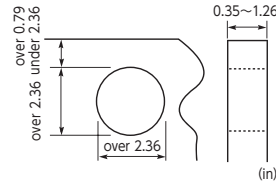

⚠ The applicable road plate thickness and hole dimensions shall be within the ranges of the drawing and the chart.

Features

- The swivel eye bolt included enables smooth returning of wire rope, thereby preventing the road plate from turning.

Item No.	Rated capacity (ton)	Size (in)														N.W. (lb)
		H	H1	H2	H3	H4	H5	L	L1	L2	R	T	T1	T2	T3	
SLH2S	2	15.83	5.79	4.61	2.76	1.97	1.18	6.54	2.95	1.85	1.50	2.13	1.81	1.14	0.75	9.26
SLH3S	3	15.94					1.30	6.65	3.07					1.22		9.92

» For Extra Safety

SLH-SC

SUPER LOCK HOOK WITH CHAIN SLING (with Swivel)

CHECK!



PDF of Catalogue



▮ Size of master link

- Inner diameter: 2.76×5.51in
- Wire diameter of master link: $\phi 0.75$ in



Features

- Chain slings can be used safely for a longer time than wire ropes.
- Including a tag showing the serial number and the rated capacity for control.
- The swivel eye bolt included enables smooth returning of the chain, thereby preventing the road plate from turning.

Item No.	Rated capacity (ton)	Set details		L (in)	N.W. (lb)
		Super lock hook item No.	Chain item No.		
SLH2SC	2	SLH2S	CSC31	55.39	16.98
SLH3SC	3	SLH3S	CSC31	55.51	17.64

» Light Weight & High Durability

CSC31

CHAIN SLING

CHECK!



PDF of Catalogue

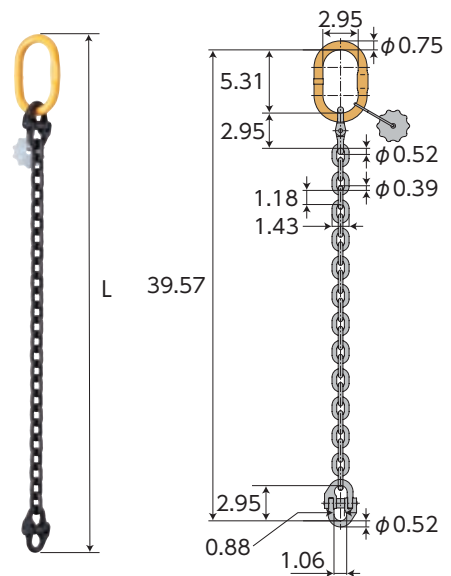

Features

- Convenient for using directly with our super lock hooks.
- Our chain slings are based on JISV class, making them light-weight and strong.

Item No.	Rated capacity (ton)	L (in)	N.W. (lb)
CSC31	3	40.83	7.72