

Low Headroom Air Trolley & Hoist ULT

ULT series hoists are designed specifically for mining, industrial and general engineering applications where headroom is extremely limited such as locomotive battery bays, pump chambers and underground workshops. They are available in geared and motorized traverse versions. The hoists operate at air pressures of between 4 and 6 bar and have a factor of safety in excess of 5 at the rated load. They comply with the requirements of SANS 1638, ASME B30.16 and EN14492-2. The manufacturing facility producing the hoists is 1509001, 5014001 & OHSAS18001 certified.



- Range — 2, 3, 4 & 6t
- Ultra-low headroom, compact and versatile
- Available in geared and motorized versions
- Greater than 5:1 factor of safety
- Integrated load limiter

Product Code	Capacity (tons, T)	Falls of Chain	Chain Size (mm, in)	Total Weight (kg*, lbs)	Full Load Lifting Speed (m/min, ft/min) @ 6 bar	Full Load Lifting Speed (m/min, ft/min) @ 4 bar	Traverse Speed (m/min, ft/min) @ 6 bar	Air Consumption (m ³ /min, cfm) @ 6 bar	Air Consumption (m ³ /min, cfm) @ 4 bar	Air Connection	Supply Hose (Inside Ø) (mm, in)	Sound Level (dB(A))	Minimum Headroom (mm)	Minimum Beam Curve Radius (mm)
ULTA2200	2.0, 2.2	2	10x28, 0.39x1.1	230, 507.1	5.3, 17.4	5.3, 17.4	3.2, 10.5	2.6, 91.8	1.7, 60.0	NPT ³ / ₄	19, 0.75	83	260, 10.2	3600, 141.7
ULTA3200	3.0, 3.3	2	10x28, 0.39x1.1	235, 518.1	4.8, 15.7	4.8, 15.7	3.0, 9.8	4.0, 141.3	2.6, 91.8	NPT1	25, 0.98	83	265, 10.4	3600, 141.7
ULTA4200	4.0, 4.4	2	10x28, 0.39x1.1	235, 518.1	3.6, 11.8	3.6, 11.8	2.3, 11.8	4.0, 141.3	2.6, 91.8	NPT1	25, 0.98	83	265, 10.4	3600, 141.7
ULTA6200	6.0, 6.6	4	10x28, 0.39x1.1	265, 584.2	2.4, 7.9	2.4, 7.9	1.5, 4.9	4.0, 141.3	2.6, 91.8	NPT1	25, 0.98	83	234, 9.2	4200, 165.4

* Weight includes 3m/10' lift, 2m/6.5' pendant control

* For longer lifts add 4.4kg/9.7lbs for the ULTA2200, ULTA3200, ULTA4200, and 8.8kg/19.5lbs for the ULTA6200.

More features of Tiger Air Trolleys

Load Limiter

Integral differential pressure load limiting valve automatically prevents the operator lifting a load of more than 125% of the working load limit. Load limiter is 100% repeatable at all working pressures and does not wear or generate damaging heat.

Emergency Stop

All hoists can be supplied with an emergency stop device as an option. This shuts off the main air supply to the hoist when activated. Resetting the device will not automatically restart the hoisting operation.

Precise Control

Accurate and precise positioning of loads is standard for both toggle and pendant control models.

Fail Safe Disc Brake

Non-asbestos self-adjusting disc brake is applied automatically when the air supply to the hoist is shut off. The brake is self-adjusting for the life of the brake and can hold more than 125 % of the working load limit.

Automatic Stopping

Motorized traverse drive stops automatically due to the worm drive when the air supply is shut off. Additional traverse brake is optional.

Integral Silencer

The exhaust air silencer limits the noise level to 83dB(A).

Load Chain

Grade 80 load chain ensures stringent high-speed duty cycles can be met. The load chain is in accordance with the requirements of SANS/ISO 3077 and EN818-7 Appendix B.

Vane Motor

Assisted vane lifting ensures maximum starting torque when starting under load.

Sealed Gearbox

The sealed planetary gearbox ensures that the most stringent duty cycles can be met. The gears are heat treated and mounted on high strength, low friction bearings.

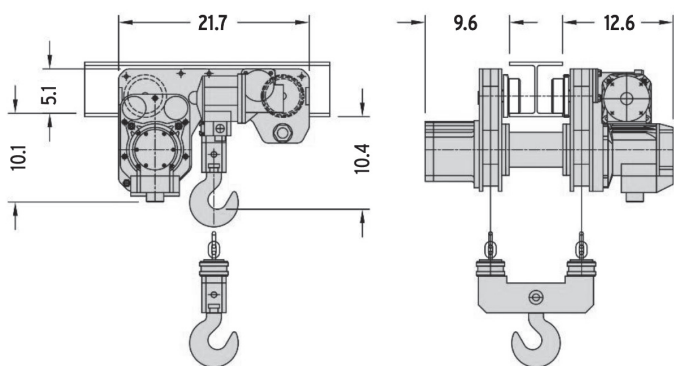

ULTA2200, ULTA3200,
& ULTA4200

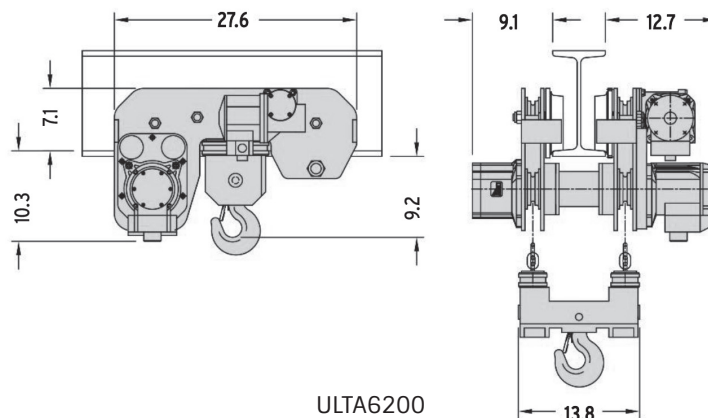

ULTA6200

How to Order: Example: ULTA6200P32

Series	Type	Max Load (kg, lb)	Attachment	Control	Pendant Type	Control Length (m, ft)
ULT	A	6, 6.6	200	P	3	2, 6.56
	A=Motorized G=Geared	2, 3, 4, or 6		P=Pendant T=Toggle		

When ordering, specify beam size, flange width and type.

