

# Adjustable Angle Beam Clamp BCA

This BCA clamp serves as an anchor or lifting point when attached to an overhead steel angle section approved for lifting applications. This clamp can be used up to a maximum of 15° from the vertical.

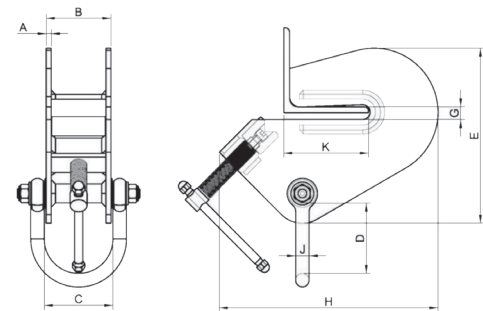

- V shaped clamping jaws ensures safe and secure grip
- Quick and versatile rigging point for hoisting equipment when attached to overhead steel angle section approved for lifting applications.
- Designed to accommodate a wide range of steel angle sections
- No tools required – integrated adjusting screw spindle
- Operating temperature of -50°C to +50°C (-58°F to +122°F)
- 1.0t and 3t capacities available
- Shackle suspension point
- 4:1 Safety factor
- These units meet and exceed all the requirements within BS EN 13155:2003+A2:2009 and AS4991



Product Code	Capacity (tons, T)	Dimensions (mm, in)									Net Weight (lb)
		A	B	C	D	E	G	H	J	K	
BCA-0100	1.0, 1.1	6, 0.2	76, 3.0	81, 3.2	83, 3.3	206, 8.1	15, 0.6	258, 10.2	16, 0.6	38-101, 1.5-4.0	12.1
BCA-0300	3.0, 3.3	10, 0.4	106, 4.2	112, 4.4	104, 4.1	343, 13.5	25, 1.0	490, 19.3	22, 0.9	101-203, 4.0-8.0	51.8